



### INSIDE BAR

Entire Beer, Liquor, N.A. Selection

### OUTSIDE BAR

Limited Beer, Liquor, N.A. Selection  
Cocktails

### THIRD BAR

.5L & 1L Fan-Favorite Beer Taps  
Roasted Nuts  
Schulz Bräu Merch

SCAN FOR BAR & KITCHEN MENUS

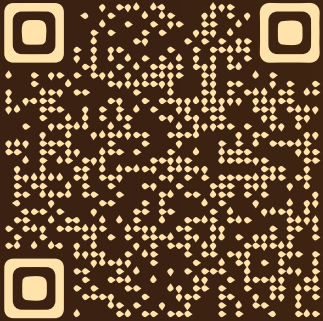

ORDER HERE



FOOD PICK-UP



WATER STATION



EMERGENCY EXIT

SCAN FOR RITTERFEST INFO

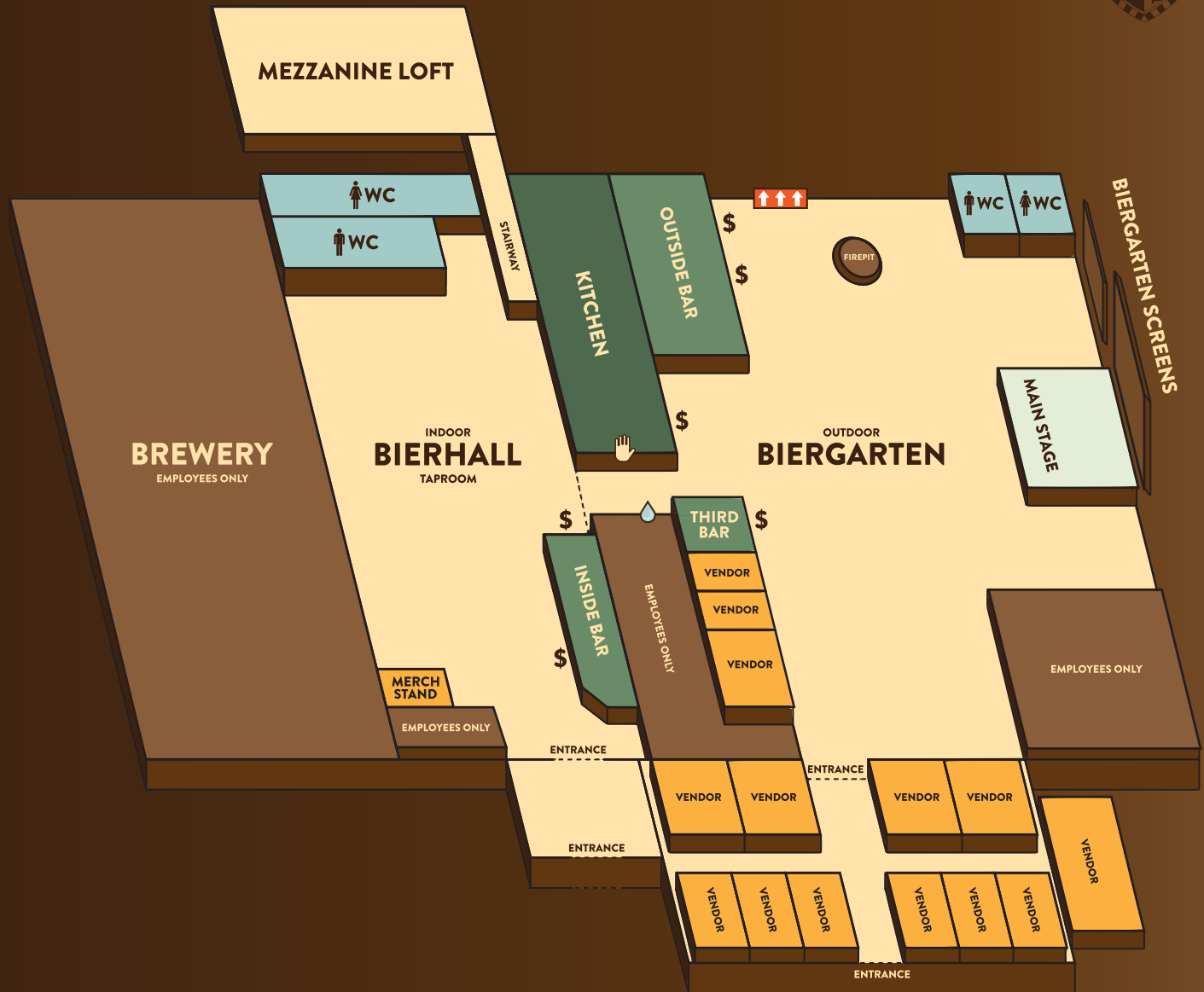
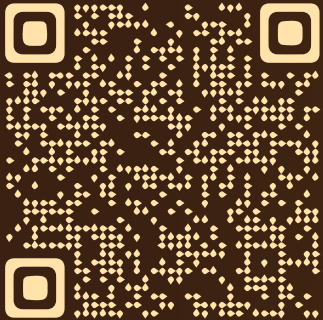

# VENUE MAP

## COMMON BREWERY & FESTIVAL Q&A's:



### Napkins, Silverware?

Find all napkin & silverware needs at the kitchen window.

\*\*\*For big spills, a bartender will come to your table with appropriate cleaning supplies.

### Dogs Allowed?

Yes! However, dogs cannot be “seated” within the taproom - outdoors only!

\*\*\*We advise caution for bringing any furry friends to festivals at Schulz Bräu due to crowds, noise, and costumed characters.

### Parking?

All labeled Schulz Bräu and street parking is free! Our neighbors, AXLE, have a private lot for their employees, so please avoid parking within this lot. No worries though - it is clearly marked to avoid any confusion!

### Costumes Allowed?

Yes! Costumes are highly encouraged for any and all Schulz Bräu events. Join in on one of our scheduled costume contests for the weekend - winner gets a prize!

### Outside Food or Drink?

Outside food is welcome at Schulz Bräu! However, outside drinks - aside from water - are **PROHIBITED** in the brewery.

### Reservations?

No table or large space reservation-requests will be accepted during Ritterfest: 4/14, 4/15, & 4/16.

### Showing Games?

For Ritterfest, no games or shows will be put up on the Jumbotrons - unless otherwise stated in the official schedule.